

GENERAL NOTES

THE DRAWING AND THE DESIGN IT CONTAINS ARE CONSIDERED TO BE THE PROPERTY OF D.F.K. ENGINEERING CANADA LIMITED. ANY UNLAWFUL REPRODUCTION OR USE FOR ANY PURPOSE WHATSOEVER EXCEPT BY WRITTEN CONSENT OF THE OWNER.

NOTE:

NO.	DATE	DESCRIPTION

SEALS

PERMIT TO PRACTICE
D.F.K. ENGINEERING CANADA LTD.
Signature: _____
Date: _____
The Association of Professional Engineers, Geologists and Geophysicists of Alberta

D.F.K. ENGINEERING CANADA LTD.
CONSULTING ENGINEERS
PH: 403.236.1095
E.M.: dfecon@rednet.ca
2120, B - 8800 VENTURE AVE S.E.
CALGARY, ALBERTA, T3S-0A2

PROJECT TITLE:
OFFICE WAREHOUSE CONDOMINIUM

240040 FRONTIER PLACE SE
ROCKY VIEW, ALBERTA.

SHEET TITLE:
**SITE PLAN
MECHANICAL LAYOUT**

DRAWN	CHECKED	APPROVED
R. KIMMAR	D. BERTON	G. P. WILSON
SCALE:	PRODUCT NO:	
AS NOTED	29-2411	
DATE:	DATE PRINTED:	REVISION:
JULY 1, 2009	AUG 20, 2009	

M-1
OF 7

LEGAL DESCRIPTION
PLAN 0814288
BLOCK 2
LOT 8
OFFICE WAREHOUSE CONDOMINIUM
240040 FRONTIER PLACE SE
ROCKYVIEW, ALBERTA

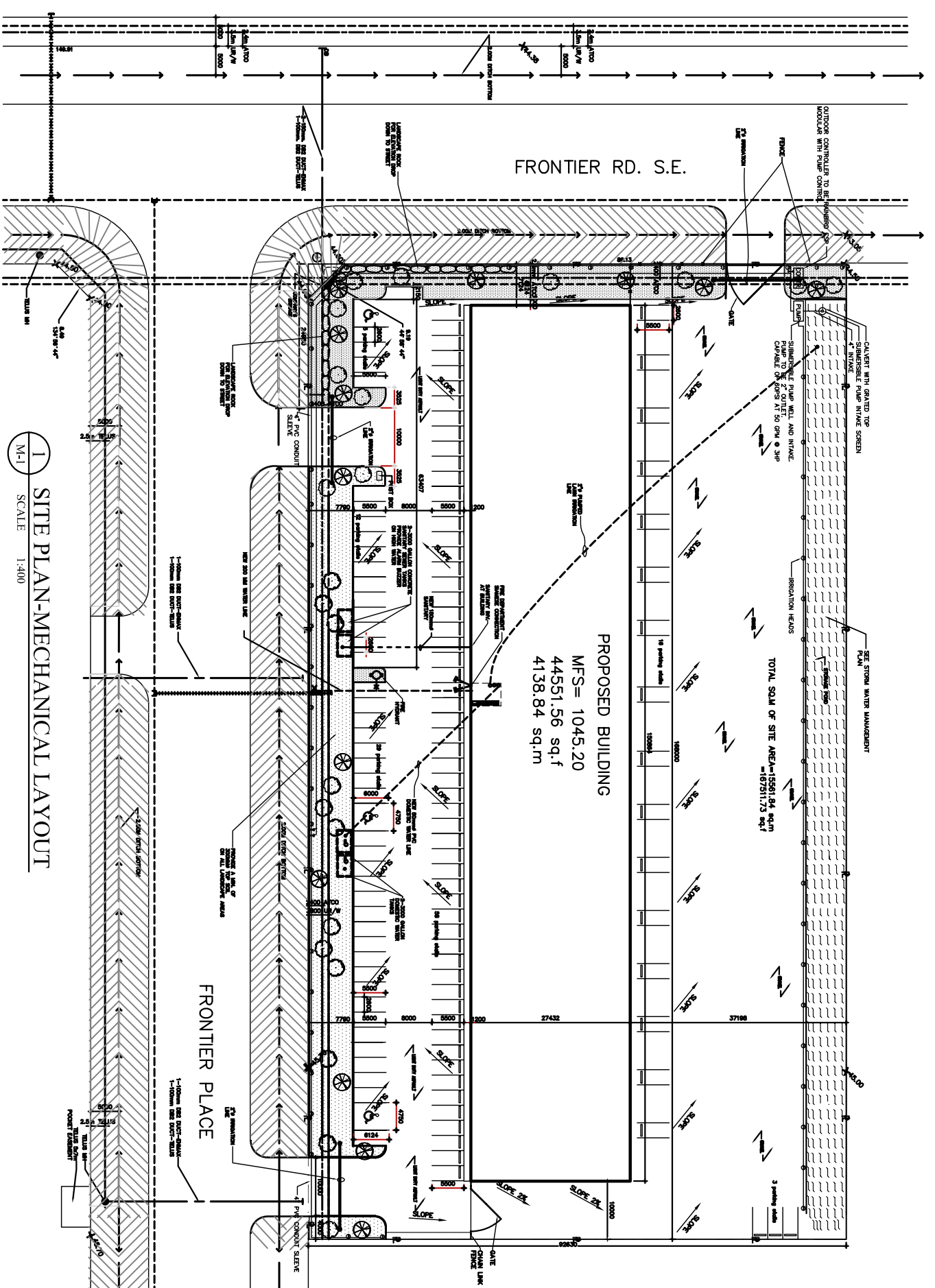

1 SITE PLAN-MECHANICAL LAYOUT
SCALE 1:400

